

Installation

Cable Preparation Details N-206

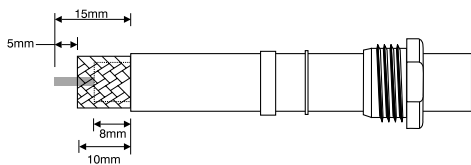
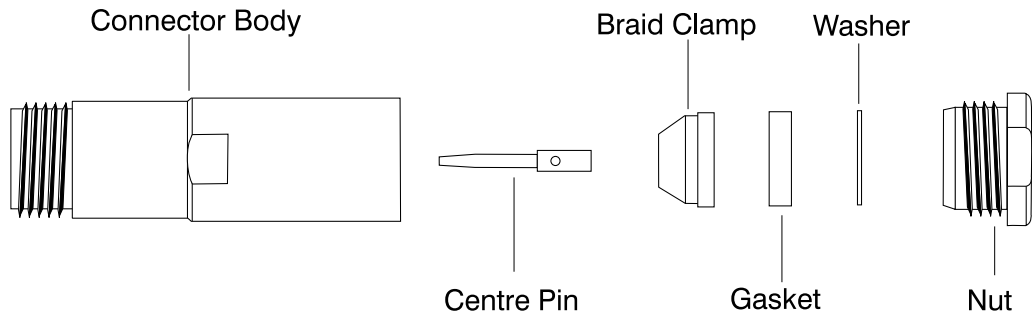

Preparation of cable

1. Slide nut, washer and gasket on to cable.
2. Strip jacket to dimensions shown.

Solder centre pin to cable centre conductor

1. Insert cable centre conductor in to centre contact until it butts against cable dielectric.
2. Solder centre contact.

Install braid clamp

1. Place braid clamp over cable braid
2. Comb braid wires out straight and fold back over front shoulder of braid clamp.
3. Trim braid wires flush with edge of braid clamp.

Final Assembly

1. Mount cable assembly and fittings into connector body.
2. Screw and tighten nut

Installation

Cable Preparation Details N-207

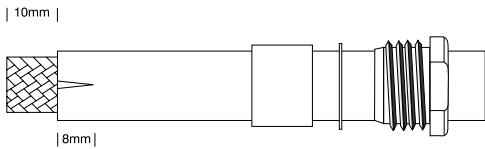
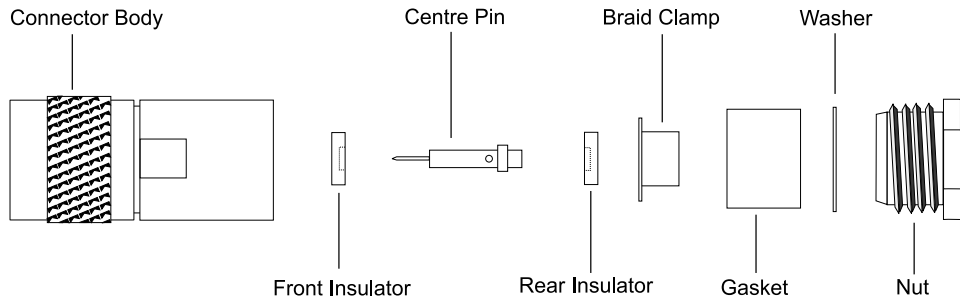

Preparation of cable

1. Slide nut and gasket on to cable.
2. Strip jacket to 10mm
3. Slit cable jacket in two places, 180° apart

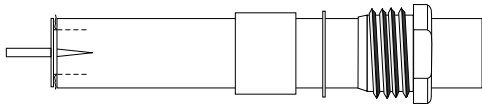

Solder centre pin to cable centre conductor

1. Fold back braid and fit braid clamp between dielectric and braid. Trim braid around braid clamp
2. Remove dielectric flush with front of braid clamp
3. Slide on rear insulator and centre pin (these parts must butt)
4. Solder centre pin to centre conductor

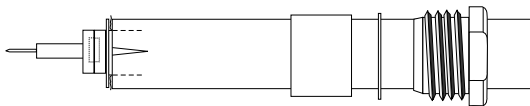

Install front insulator

1. Install front insulator over centre pin

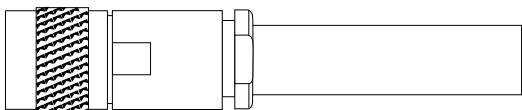

Final Assembly

1. Mount cable assembly and fittings in to connector body
2. Screw and tighten nut